

# Optimal venous sensor set-up

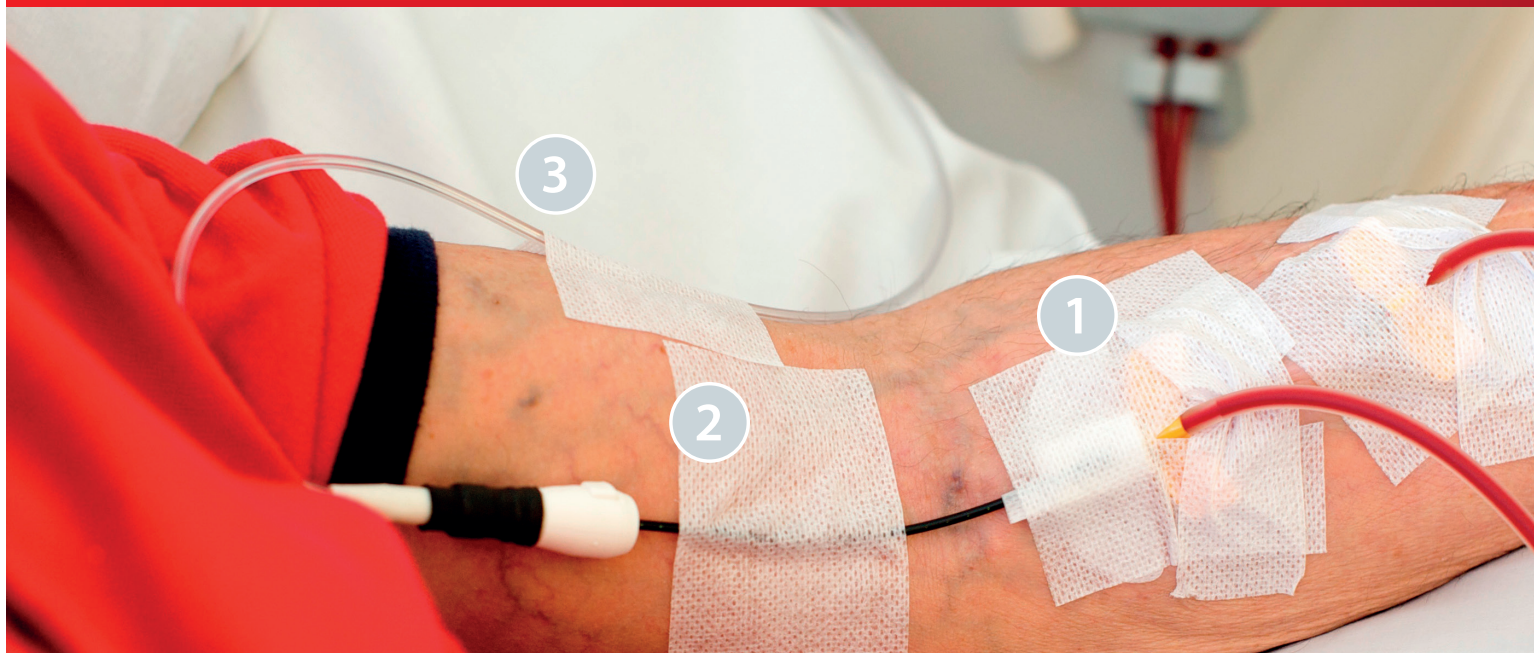

## 1. Sensor Patch Placement

- Position the foam edge slightly over the needle insertion point.
- Ensure the black fiber lies straight with no tension or kinks.

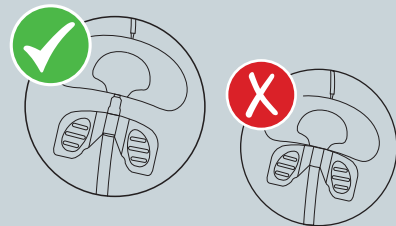

## 2. Orientation

- Place the patch opposite the blood lines so it remains in place if a needle dislodges.
- Ensure the foam can absorb any blood reaching the site.

## 3. Cable Management

- Keep the FOE cable loose and free of tension.
- Secure lightly to the skin to prevent pulling during arm movement.

## Why Correct Setup Matters

Proper placement helps maintain continuous sensing and reduces false or missed alarms.

Instruction guides:



# Optimal catheter sensor set-up

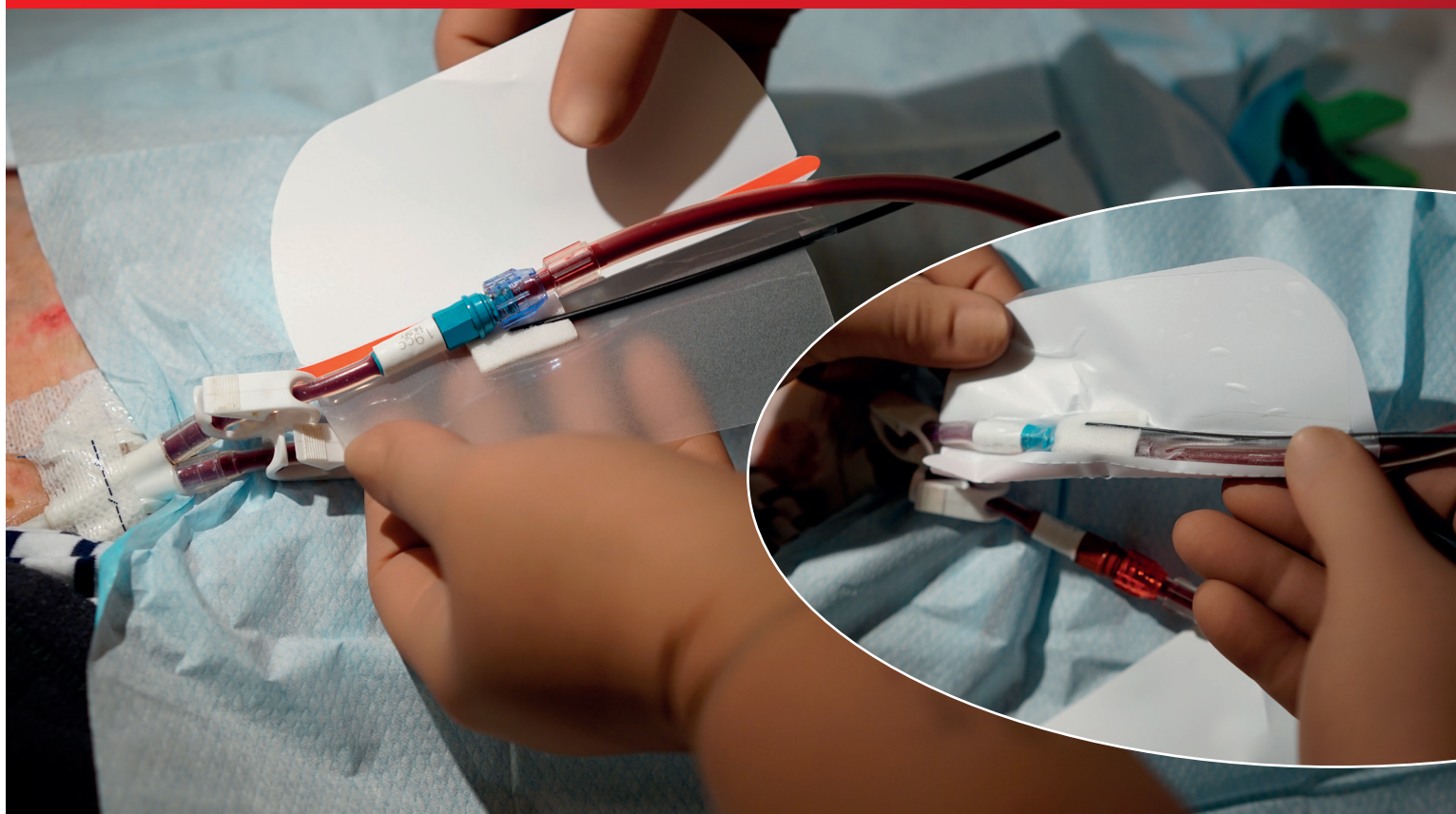

Place the Luerlock connector onto the absorbent foam, align the blood tube along the red line, fold, and adhere the patch.

After treatment, open the patch along the red tear strip.

